



Ayrstone AyrMesh[®] Bridge Setup

Quickstart Guide
Ayrstone.com

Check the contents of the box:

- AyrMesh Bridge (2 radios)
- Power Supplies (2)
- Power Cords (2)
- Ethernet Cables (2)
- Zip Ties (4 - not shown)

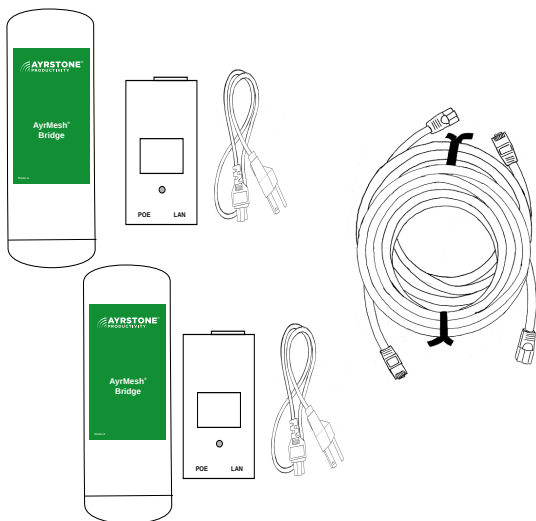

1 Start Here

Quickstart Guide- AyrMesh Bridge

Visit [Ayrstone.com/support](https://www.ayrstone.com/support)
For detailed instructions,
slideshows, troubleshooting
guides, etc.

NOTE: The AyrMesh Bridge consists of two radios - the "Gateway" radio, which is connected to your existing network, and the "Remote" radio, which is connected to the device you want connected to your network

Open the bottom door of the radio by lifting the tab on the bottom and sliding the door open. Write down the MAC addresses from inside the bottom of your AyrMesh Bridge radios - keep them in a safe place

If you don't have one, sign up for an account on [AyrMesh.com](https://www.ayrstone.com/support)

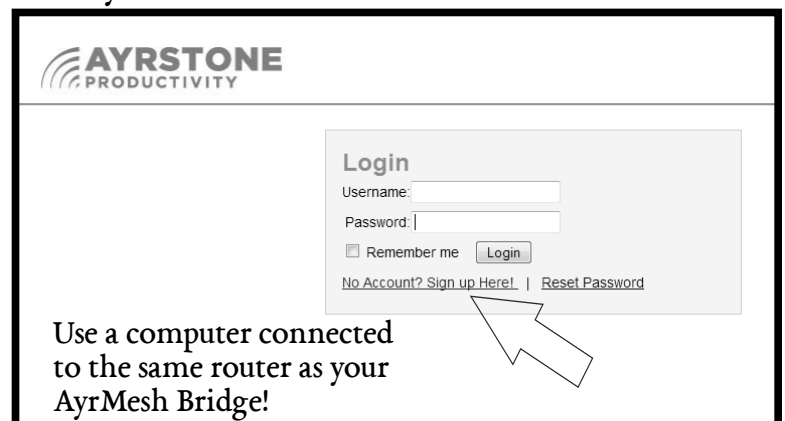
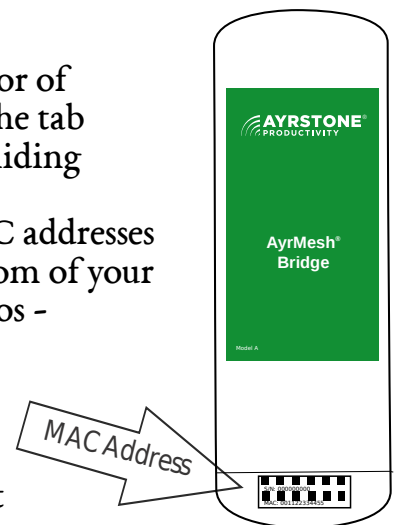

Use a computer connected to the same router as your AyrMesh Bridge!

2

Using the AyrMesh Bridge

The AyrMesh Bridge is useful for several purposes, including relocating the AyrMesh Gateway Hub far from your router (e.g. on top of a grain leg) or jumping your network from one field to another to extend your AyrMesh WiFi network.

Using the AyrMesh Bridge is extremely simple: mount the "Gateway" radio up high and in the clear, pointing where the "Remote" radio will be. Plug the "Remote" end into the device that you want on the network. Just plug whatever device you want to have on your network into the "LAN" port of the Remote Bridge radio's power supply.

Using the AyrMesh Bridge to relocate a Gateway Hub

Gateway Radio

Remote Radio

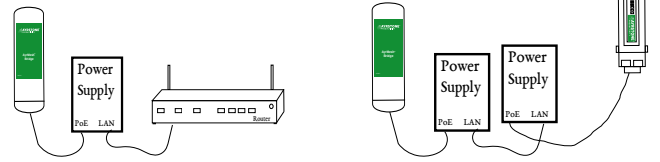

Using the AyrMesh Bridge to "jump" to a distant field

End of Field 1:

Start of Field 2:

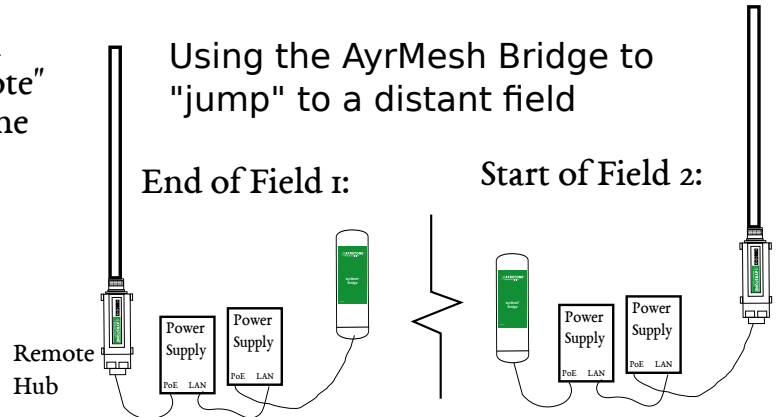

3

Assemble and attach to router

NOTE: Each Bridge radio must be "initialized" by connecting it to your router until it checks in to your AyrMesh.com account. This usually takes a minute or so, but may take a little longer.

Please initialize the Bridge Radios individually to avoid creating a network loop.

Click one end of an Ethernet cable into the port on the power supply marked "POE"

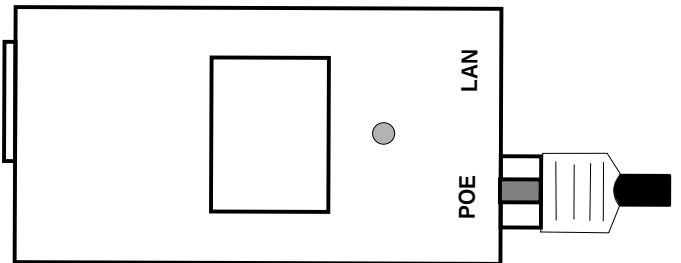

Use another Ethernet cable to connect the LAN port of the power supply to one of the LAN ports on your router.

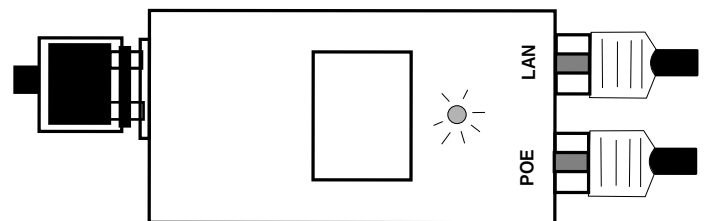

Connect the power cable to the power supply

4

Connect the Bridge Radio



Plug the other end of the Ethernet cable from the "POE" side of the power supply into the POE/LAN port (the left port as you are looking at the bottom) on the Bridge radio - slide in until it clicks in place.

DO NOT FORCE CABLES INTO OR OUT OF PORTS!

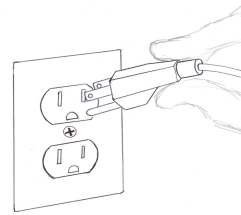

Plug in the power supply. This is how the whole thing should look:

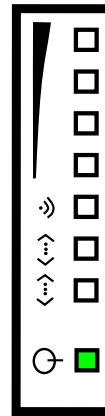
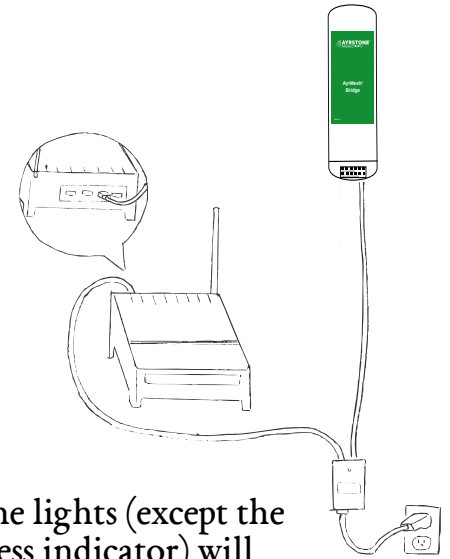

All the lights (except the wireless indicator) will come on, then the power light (on the bottom) will stay on.

5

Let the Bridge initialize itself

Each Bridge radio will check in to AyrMesh.com to download the configuration parameters for your account. This usually takes a few minutes, but may take longer.

When the Bridge Radio is booting, the top signal light (leftmost) will flash. Then the signal lights (top 4 lights) will start out "running" from bottom (red) to top (green). When the Bridge Radio has checked in to AyrMesh.com, the top (green) signal light will be on and steady, along with the power, wireless, and Ethernet lights, as shown:

Do NOT remove the Bridge radio from the router until after you see this light pattern.

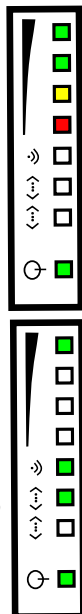

6

Finish the Installation

Each Bridge radio should be mounted outside, up as high as possible, with the front pointing at the other Bridge radio. Maximum range for the Bridge depends on having clear line-of-sight.

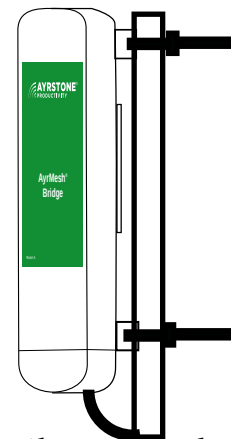

The Bridge is easily mounted to a pole with two zip-ties, as shown, but has screw holes on the mounting pylons for mounting on a flat surface. The Ethernet Cable is connected to the PoE port of the power supply - remember to put the door back on the radio.

7 Signal Lights on the Remote Half

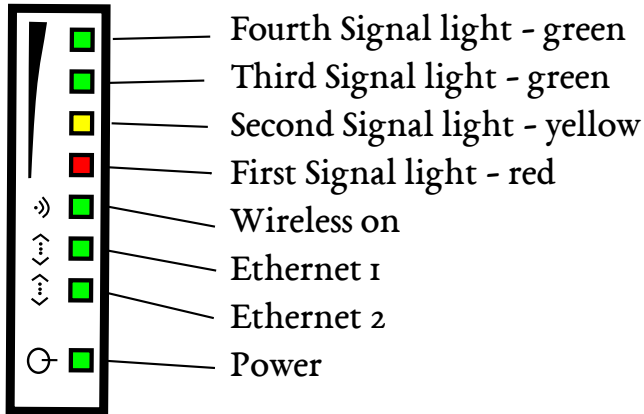

The Remote Bridge radio uses the signal lights to show the signal strength from the Gateway radio. The signal strength is exhibited as follows:

- Just the first (red) signal light - very low signal
- First and second (yellow) light - good signal
- First, second, third (green) light - very good
- All 4 signal lights - excellent signal

The signal lights on a Bridge Remote are refreshed approximately once per second.

Only the top (leftmost) signal light remains lit on the Bridge Gateway Radio.

NOTE: To prevent water damage, make sure Bridge radios are mounted straight up and that the Ethernet cable has a "drip loop" where it enters any building.

8 Troubleshooting

1. Ethernet Light does not come on, or Bridge does not appear in router's DHCP table, or bridge radio never checks in to AyrMesh.com
 - Check all cables between router and Bridge radio
2. Ethernet Light comes on, Bridge radio appears in router's DHCP table, but Bridge radio does not check in to AyrMesh.com
 - Add Bridge radio's MAC address to your AyrMesh.com account manually
3. Signal lights do not come on once installed
 - Make sure Remote radio is pointed at Gateway radio and is in range.

See <http://ayrstone.com/support> for additional information, hints, and troubleshooting tips.